

ENCIMERA
(Vanity Top)

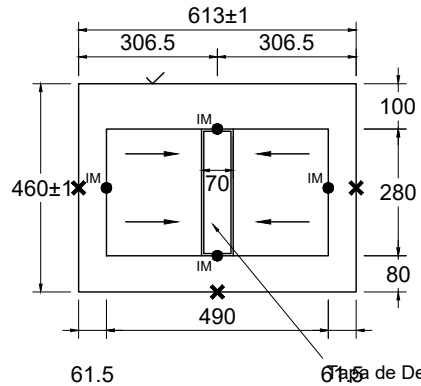

61.5 de Dekton que oculta la válvula
(Dekton lid to cover the drainer)

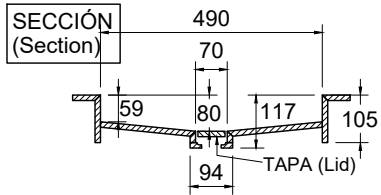

SECCIÓN
(Section)

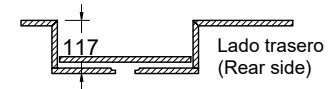

CUBETA
(Basin)

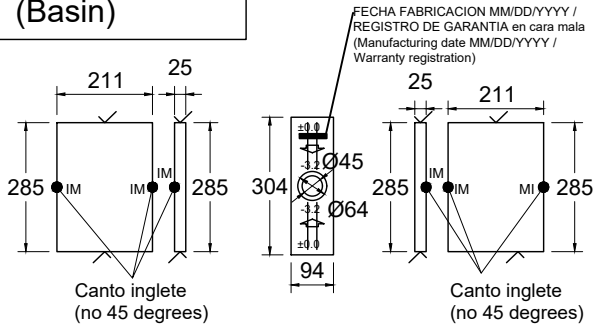

ESQUEMA DE MONTAJE
(Assembly scheme)

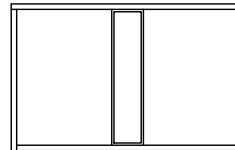

DETALLE VÁLVULA
(Drain hole detail)

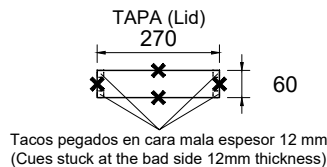
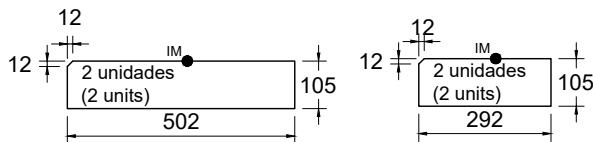
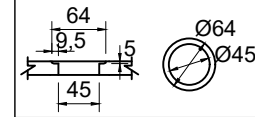

- ✱ CANTO RECTO PULIDO (Flat polished edge)
- ✓ BISEL 2 MM (Bevel 2mm)
- CANTO INGLETE 45° A LA CARA MALA (Miter edge 45°)

Måltegning Servant

DEKTON

61

ENCIMERA
(Vanity Top)



Måltegning Servant

DEKTON

76

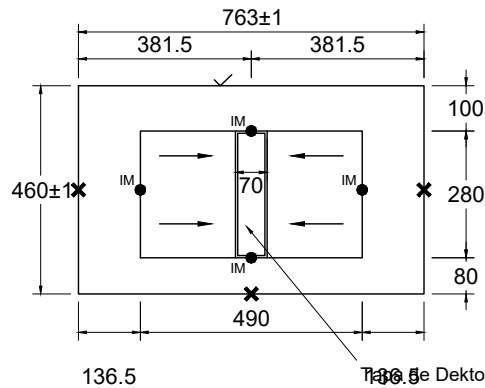

136.5 Tapa de Dekton que oculta la válvula
(Dekton lid to cover the drainer)

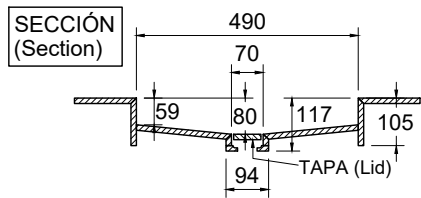

SECCIÓN
(Section)

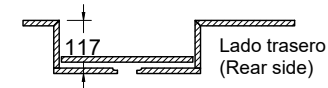

CUBETA
(Basin)

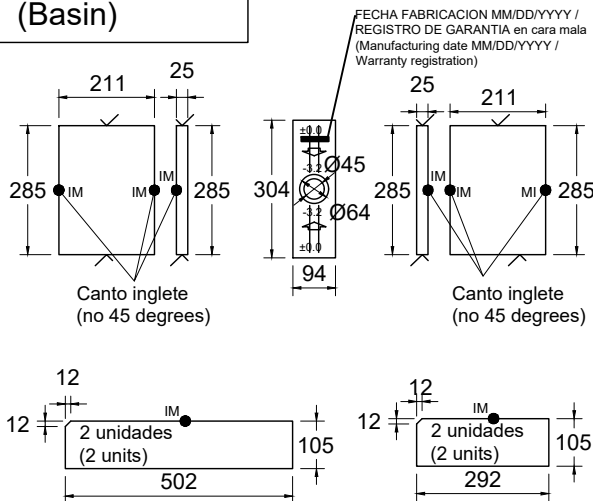

ESQUEMA DE MONTAJE
(Assembly scheme)

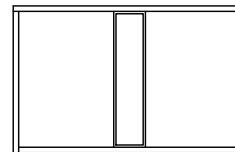

DETALLE VÁLVULA
(Drain hole detail)

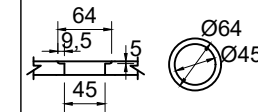

- ✱ CANTO RECTO PULIDO (Flat polished edge)
- ✓ BISEL 2 MM (Bevel 2mm)
- CANTO INGLETE 45° A LA CARA MALA (Miter edge 45°)

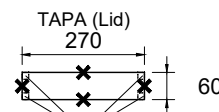

Tacos pegados en cara mala espesor 12 mm
(Cues stuck at the bad side 12mm thickness)

ENCIMERA
(Vanity Top)

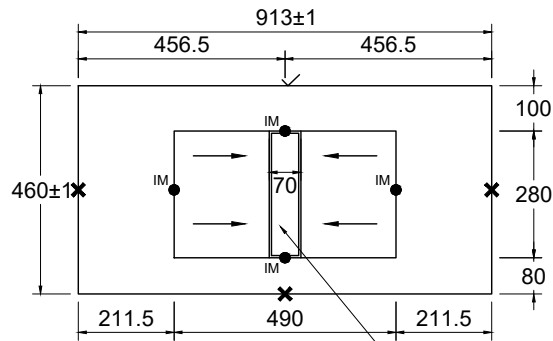

Tapa de Dekton que oculta la válvula
(Dekton lid to cover the drainer)

SECCIÓN
(Section)

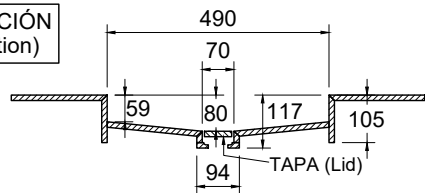

SECCIÓN
(Section)

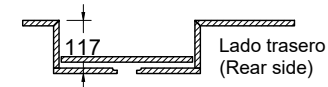

CUBETA
(Basin)

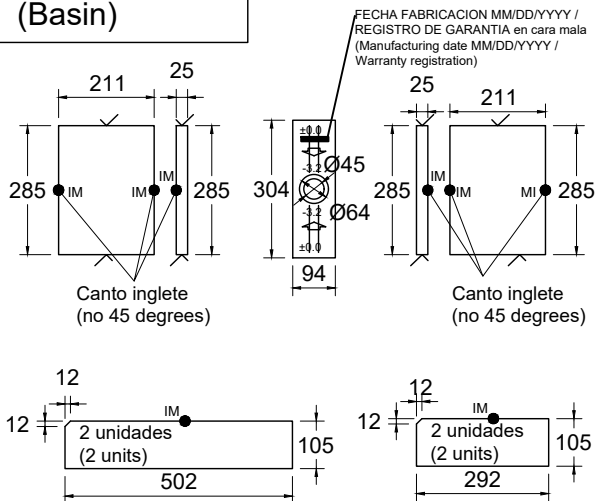

FECHA FABRICACION MM/DD/YYYY /
REGISTRO DE GARANTIA en cara mala
(Manufacturing date MM/DD/YYYY /
Warranty registration)

ESQUEMA DE MONTAJE
(Assembly scheme)

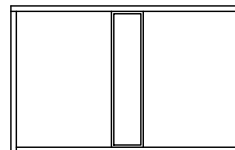

DETALLE VÁLVULA
(Drain hole detail)

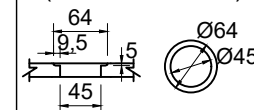

- ✱ CANTO RECTO PULIDO (Flat polished edge)
- ∨ BISEL 2 MM (Bevel 2mm)
- CANTO INGLETE 45° A LA CARA MALA (Miter edge 45°)

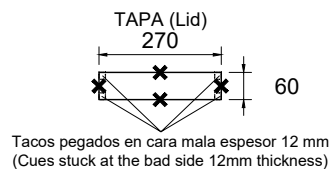

Tacos pegados en cara mala espesor 12 mm
(Cues stuck at the bad side 12mm thickness)

Måltegning Servant

DEKTON

91

ENCIMERA
(Vanity Top)



Måltegning Servant

DEKTON

121 Midtstilt

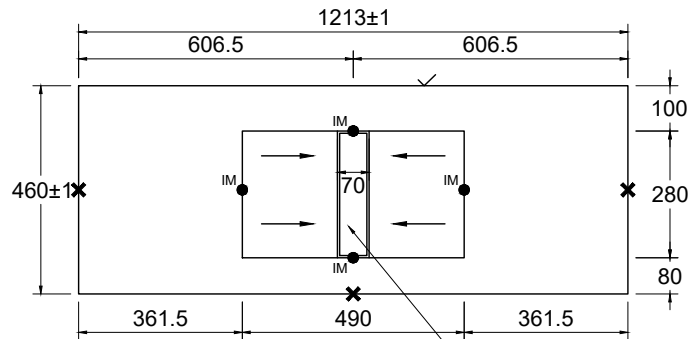

Tapa de Dekton que oculta la válvula
(Dekton lid to cover the drainer)

SECCIÓN
(Section)

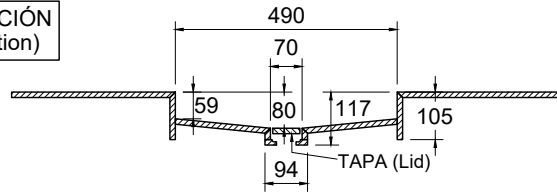

SECCIÓN
(Section)

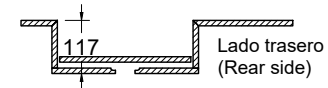

CUBETA
(Basin)

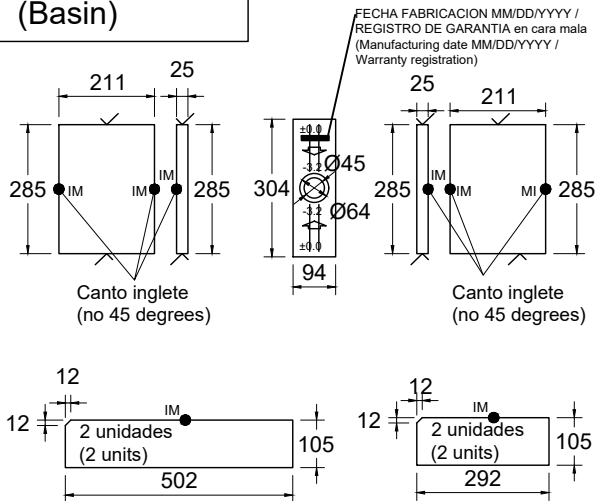

ESQUEMA DE MONTAJE
(Assembly scheme)

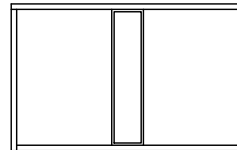

DETALLE VÁLVULA
(Drain hole detail)

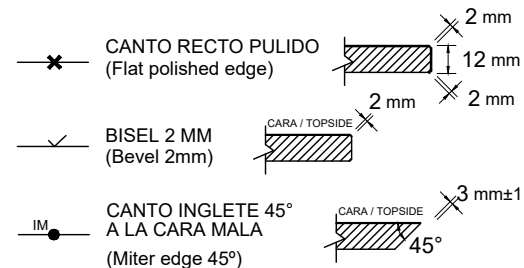
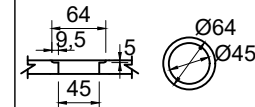

ENCIMERA
(Vanity Top)



Måltegnig Servant

DEKTON

121 Venstre

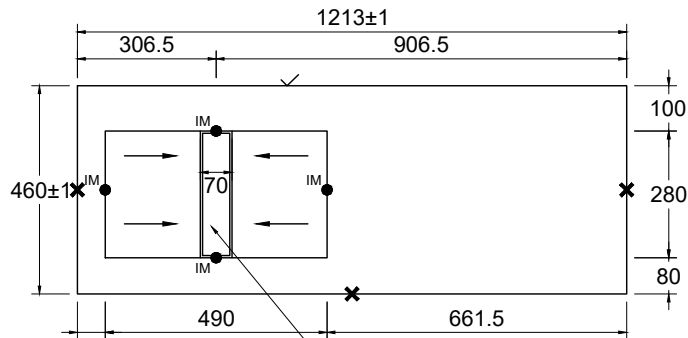

Tapa de Dekton que oculta la válvula
(Dekton lid to cover the drainer)

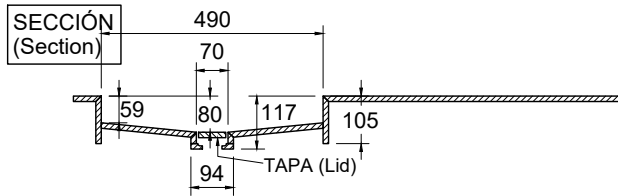

SECCIÓN
(Section)

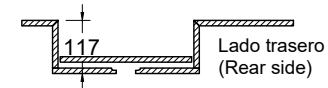

Lado trasero
(Rear side)

CUBETA
(Basin)

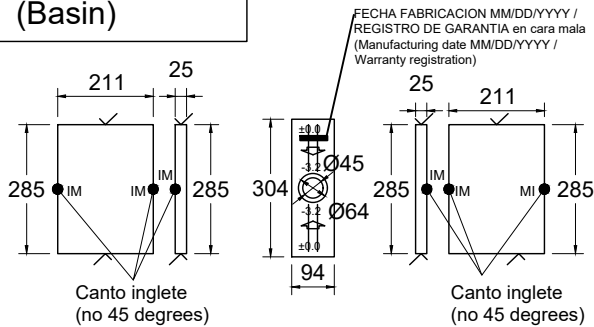

FECHA FABRICACION MM/DD/YYYY /
REGISTRO DE GARANTIA en cara mala
(Manufacturing date MM/DD/YYYY /
Warranty registration)

ESQUEMA DE MONTAJE
(Assembly scheme)

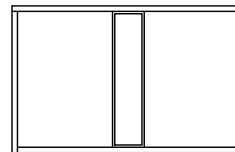

DETALLE VÁLVULA
(Drain hole detail)

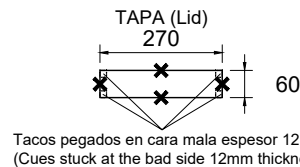
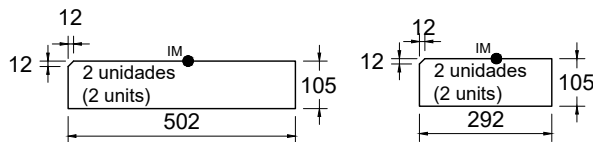
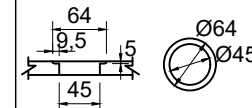

Tacos pegados en cara mala espesor 12 mm
(Cues stuck at the bad side 12mm thickness)

- ✱ CANTO RECTO PULIDO
(Flat polished edge)
- ✓ BISEL 2 MM
(Bevel 2mm)
- IM CANTO INGLETE 45°
A LA CARA MALA
(Miter edge 45°)

ENCIMERA
(Vanity Top)

DEKTON®
Designed by COSENTINO

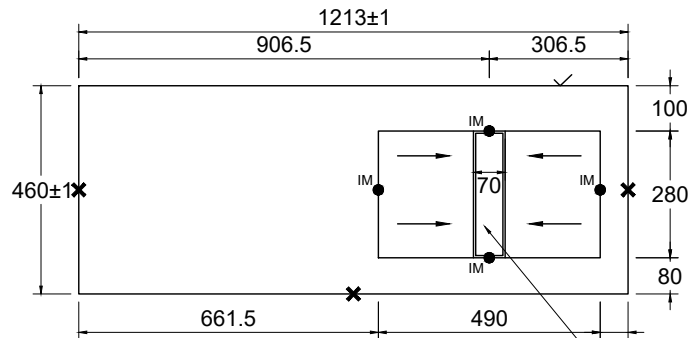

70 de Dekton que oculta la válvula
(Dekton lid to cover the drainer)

SECCIÓN
(Section)

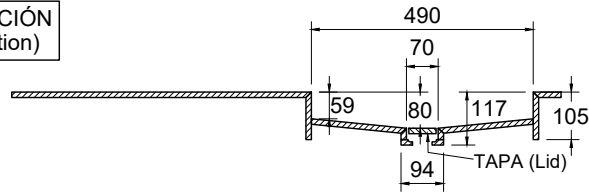

SECCIÓN
(Section)

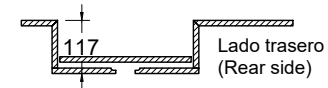

CUBETA
(Basin)

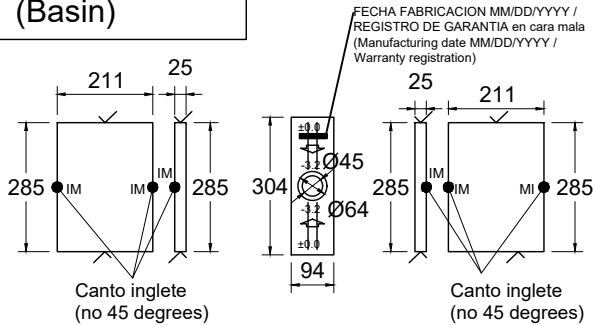

FECHA FABRICACION MM/DD/YYYY /
REGISTRO DE GARANTIA en cara mala
(Manufacturing date MM/DD/YYYY /
Warranty registration)

ESQUEMA DE MONTAJE
(Assembly scheme)

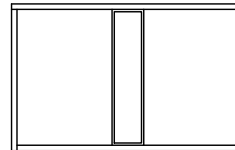

DETALLE VÁLVULA
(Drain hole detail)

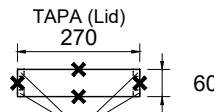
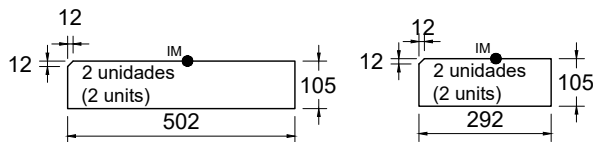
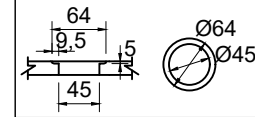

Tacos pegados en cara mala espesor 12 mm
(Cues stuck at the bad side 12mm thickness)

- ✱ CANTO RECTO PULIDO (Flat polished edge)
- ∨ BISEL 2 MM (Bevel 2mm)
- CANTO INGLETE 45° A LA CARA MALA (Miter edge 45°)

Måltegning Servant

DEKTON

121 Høyre

Scala Bad
DESIGN

ENCIMERA
(Vanity Top)

DEKTON
Designed by COSENTINO

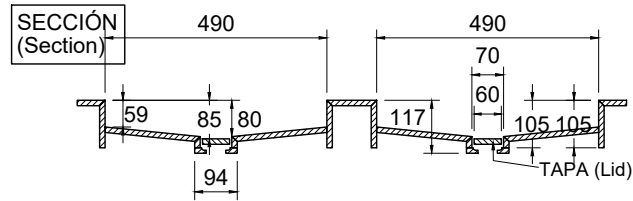
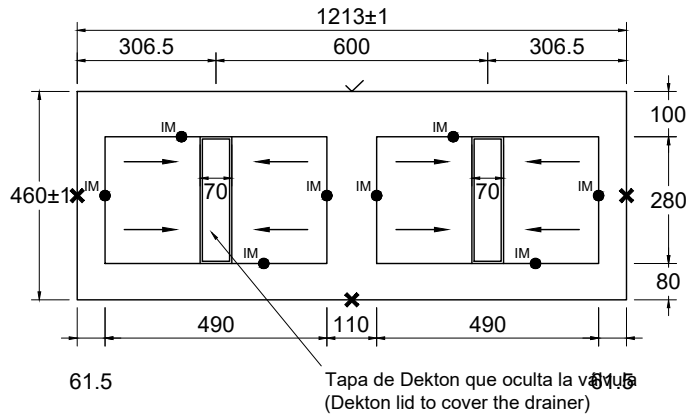

CUBETA (Basin) 2 un

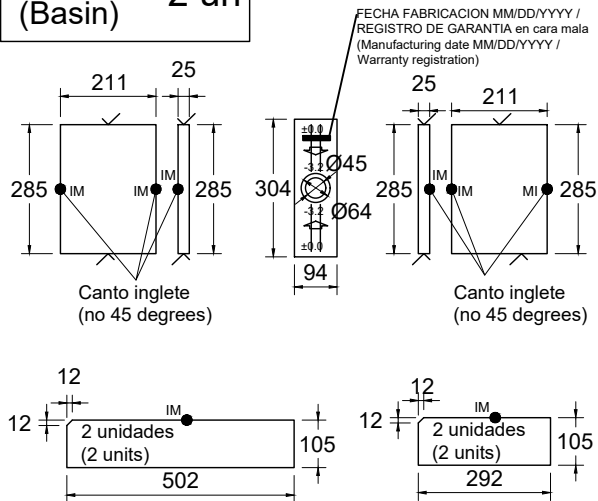

ESQUEMA DE MONTAJE (Assembly scheme)

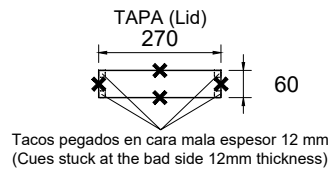
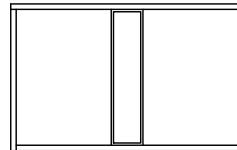

SECCIÓN (Section)

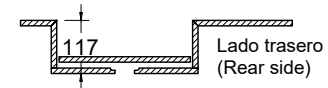

DETALLE VÁLVULA (Drain hole detail)

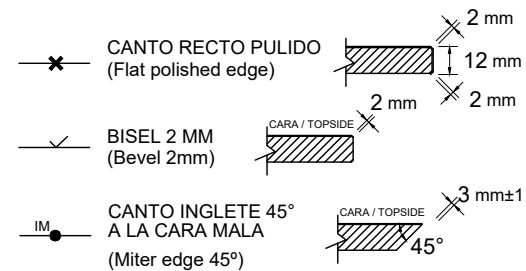
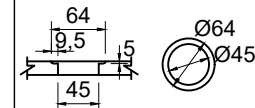

Måltegnig Servant

DEKTON

121 Dobbelt

Scala Bad
DESIGN

ENCIMERA
(Vanity Top)

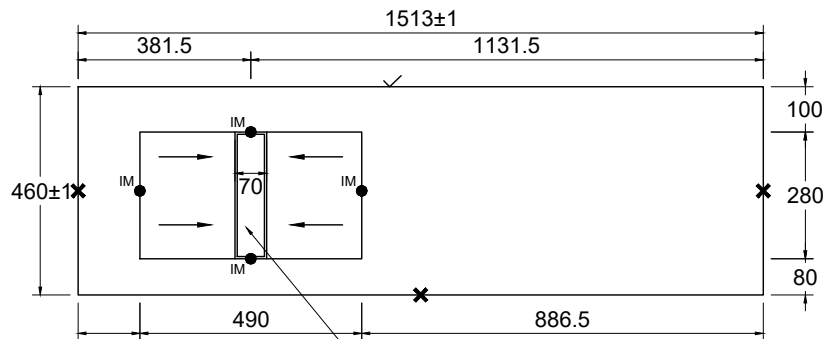

Tapa de Dekton que oculta la válvula
(Dekton lid to cover the drainer)

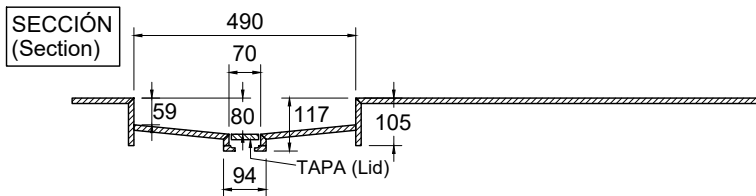

CUBETA
(Basin)

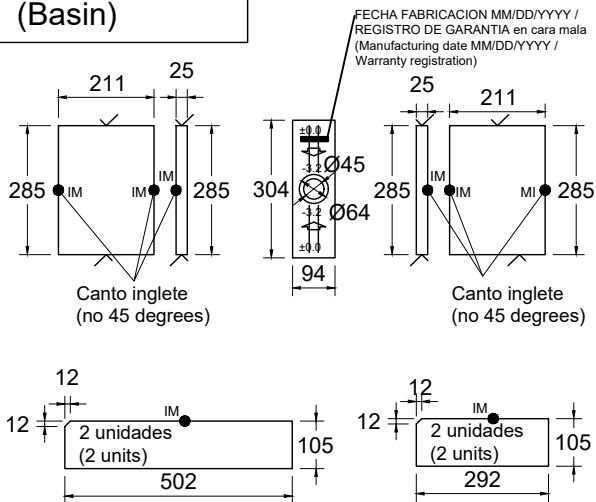

ESQUEMA DE MONTAJE
(Assembly scheme)

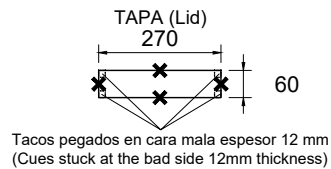
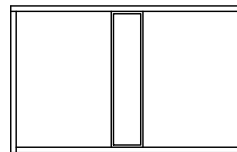

SECCIÓN
(Section)

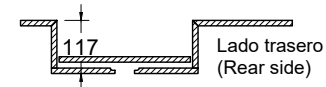

DETALLE VÁLVULA
(Drain hole detail)

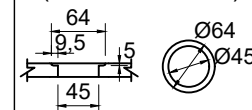

- ✱ CANTO RECTO PULIDO
(Flat polished edge)
 - ↙ BISEL 2 MM
(Bevel 2mm)
 - CANTO INGLETE 45°
A LA CARA MALA
(Miter edge 45°)
-

Måltegnig Servant

DEKTON

151Venstre

ENCIMERA
(Vanity Top)



Måltegning Servant

DEKTON

151 Høyre

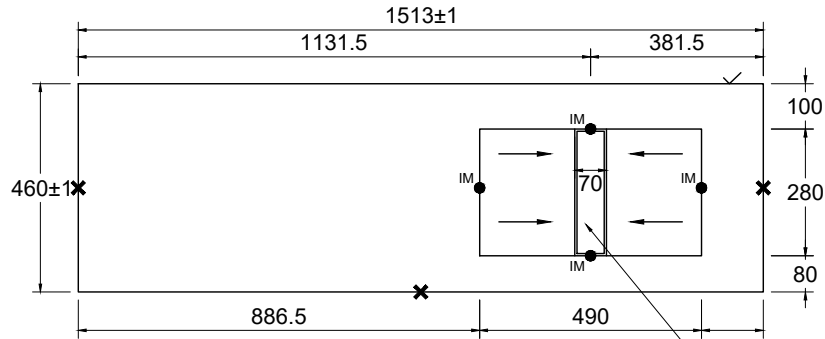

Tapa de Dekton que oculta la válvula
(Dekton lid to cover the drainer)

SECCIÓN
(Section)

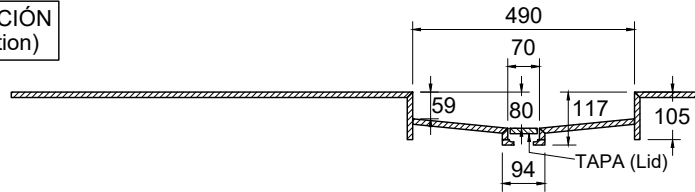

SECCIÓN
(Section)

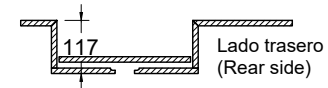

CUBETA
(Basin)

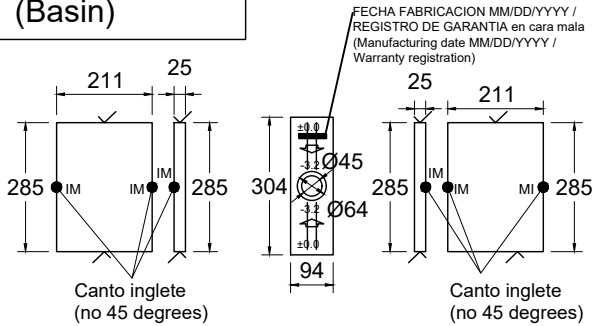

ESQUEMA DE MONTAJE
(Assembly scheme)

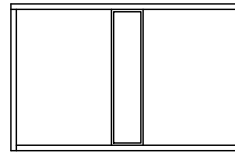

DETALLE VÁLVULA
(Drain hole detail)

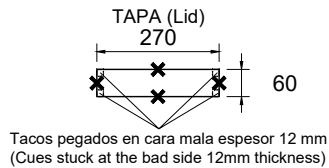
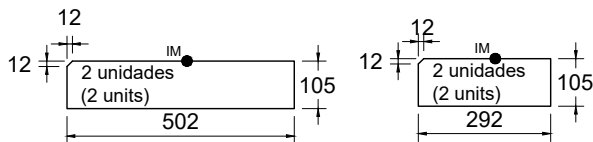
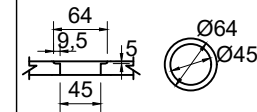

- ✱ CANTO RECTO PULIDO
(Flat polished edge)
 - ∨ BISEL 2 MM
(Bevel 2mm)
 - CANTO INGLETE 45°
A LA CARA MALA
(Miter edge 45°)
-

ENCIMERA (Vanity Top)

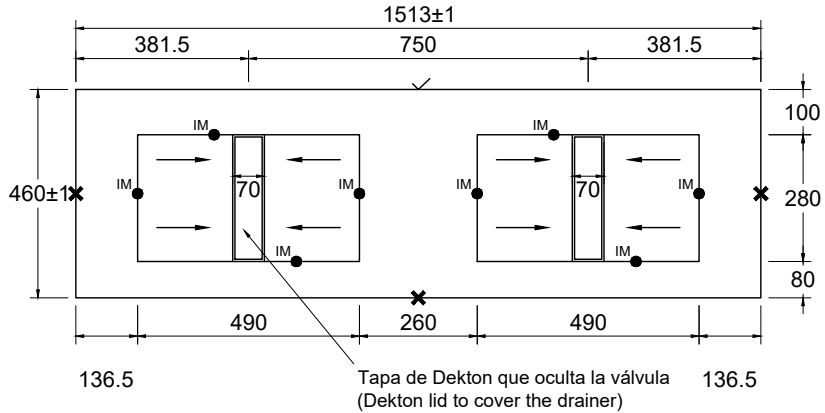

SECCIÓN (Section)

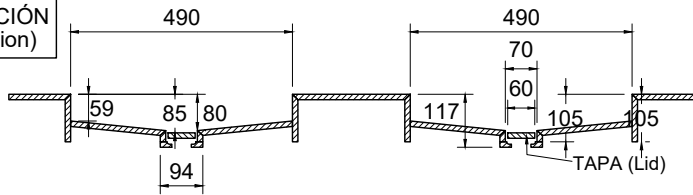

SECCIÓN (Section)

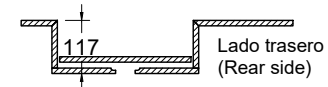

CUBETA 2 un (Basin) 2 un

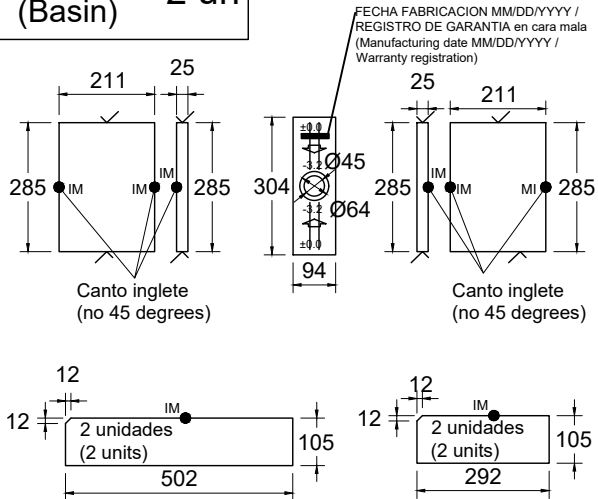

ESQUEMA DE MONTAJE (Assembly scheme)

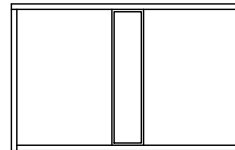

DETALLE VÁLVULA (Drain hole detail)

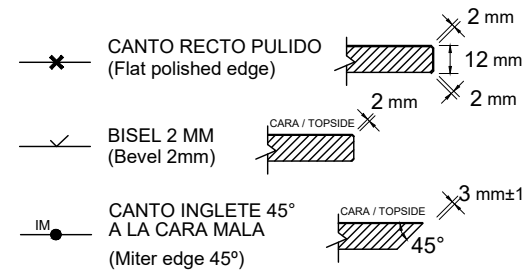
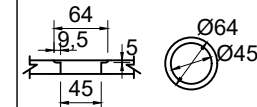

Måltegnning Servant

DEKTON

151 Dobbel

ENCIMERA
(Vanity Top)

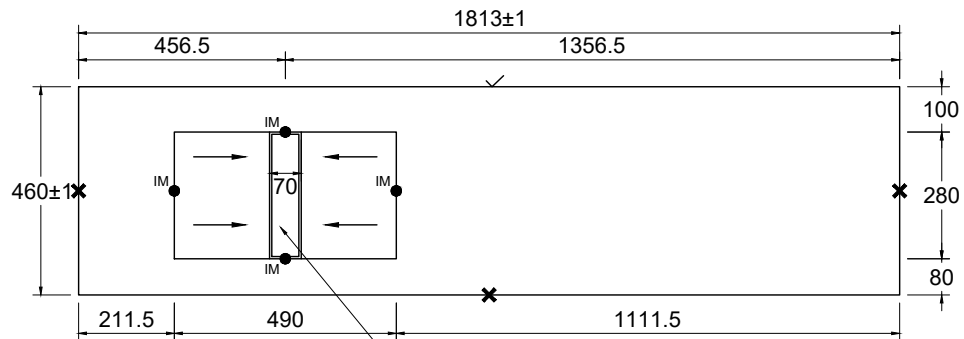

Tapa de Dekton que oculta la válvula
(Dekton lid to cover the drainer)

SECCIÓN
(Section)

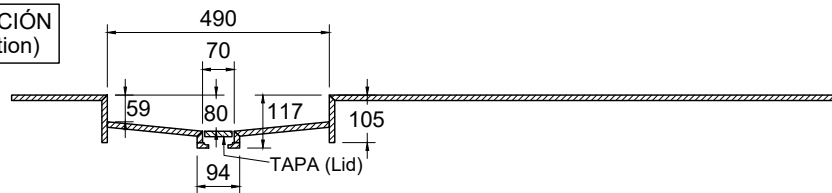

SECCIÓN
(Section)

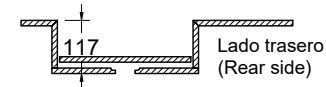

CUBETA
(Basin)

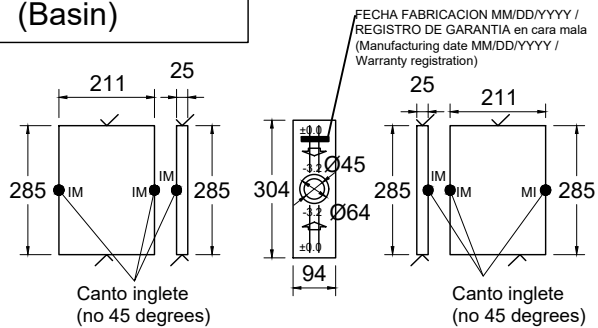

FECHA FABRICACION MM/DD/YYYY /
REGISTRO DE GARANTIA en cara mala
(Manufacturing date MM/DD/YYYY /
Warranty registration)

ESQUEMA DE MONTAJE
(Assembly scheme)

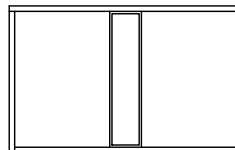

DETALLE VÁLVULA
(Drain hole detail)

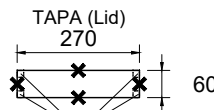
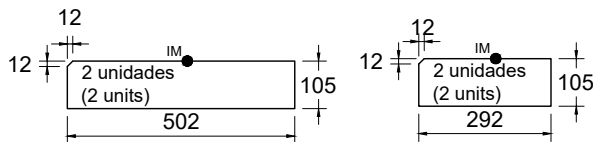
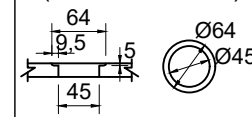

Tacos pegados en cara mala espesor 12 mm
(Cues stuck at the bad side 12mm thickness)

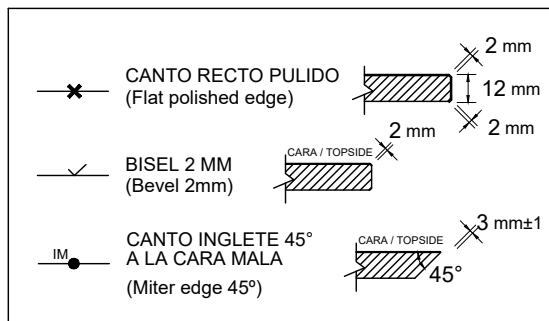

Måltegning Servant

DEKTON

181 Venstre

ENCIMERA
(Vanity Top)

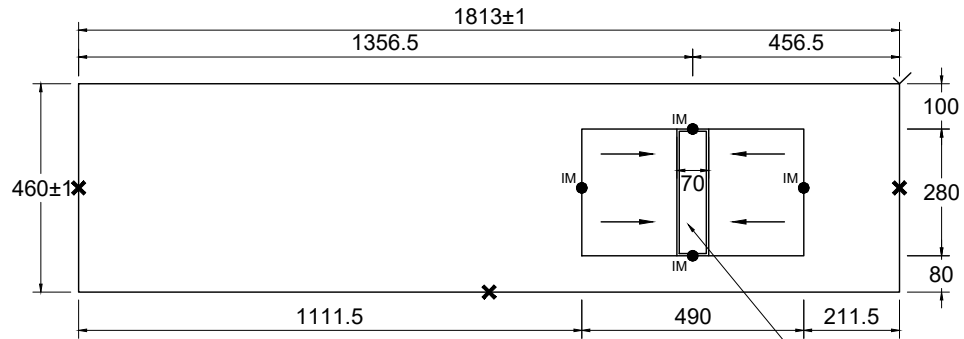

Tapa de Dekton que oculta la válvula
(Dekton lid to cover the drainer)

SECCIÓN
(Section)

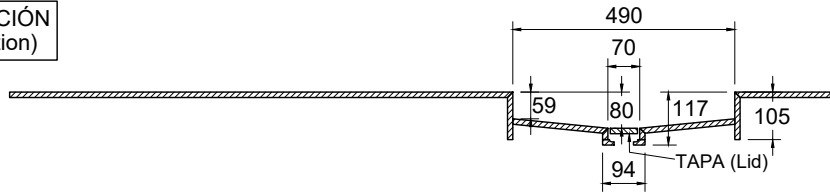

SECCIÓN
(Section)

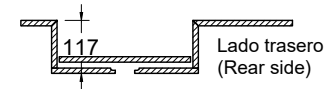

CUBETA
(Basin)

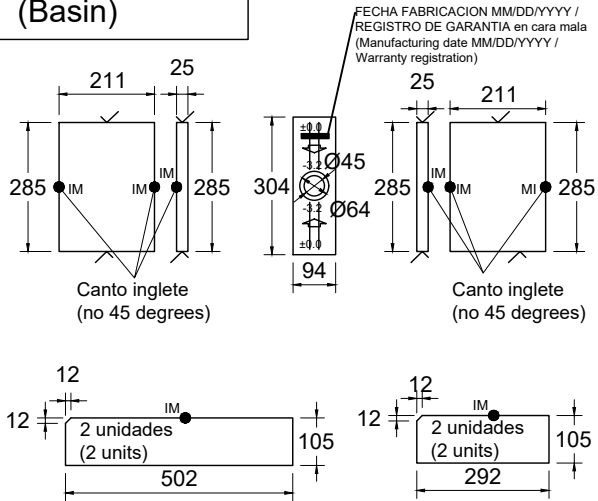

ESQUEMA DE MONTAJE
(Assembly scheme)

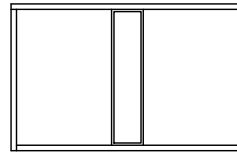

DETALLE VÁLVULA
(Drain hole detail)

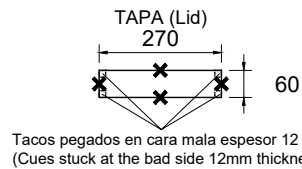
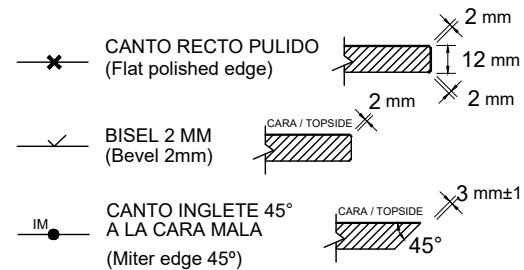
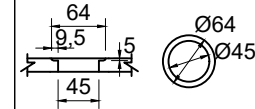

Måltegning Servant

DEKTON

181 Høyre

Scala Bad
DESIGN

ENCIMERA
(Vanity Top)

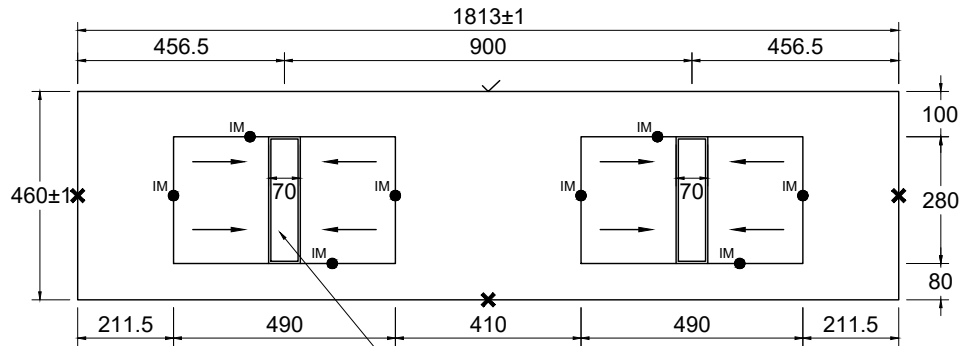

Tapa de Dekton que oculta la válvula
(Dekton lid to cover the drainer)

SECCIÓN
(Section)

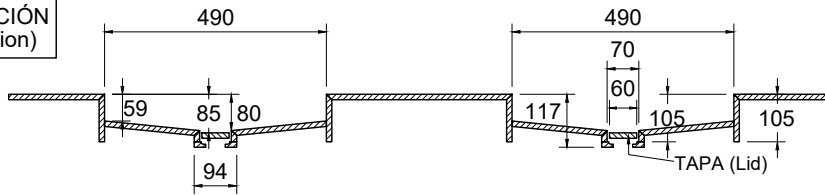

SECCIÓN
(Section)

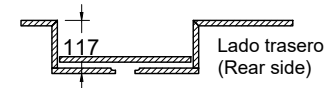

CUBETA
(Basin) 2 un

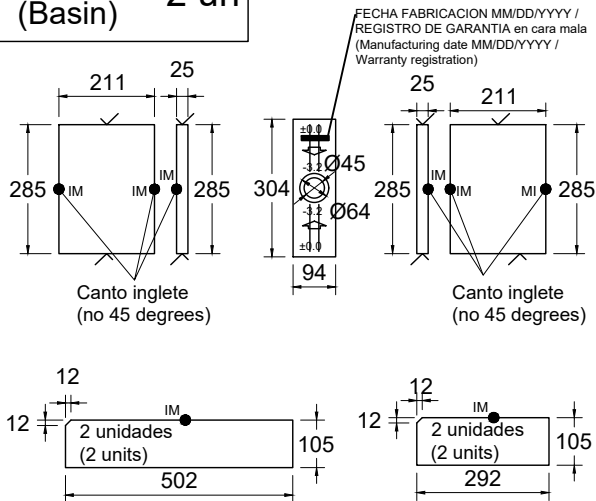

ESQUEMA DE MONTAJE
(Assembly scheme)

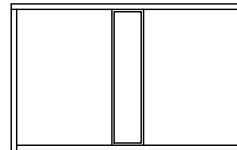

DETALLE VÁLVULA
(Drain hole detail)

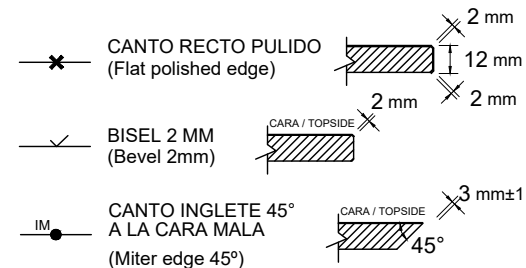
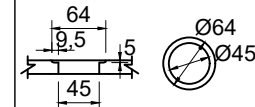

Måltegnning Servant

DEKTON

181 Dobbelt

ENCIMERA
(Vanity Top)



Måltegning Servant

DEKTON

241 Venstre

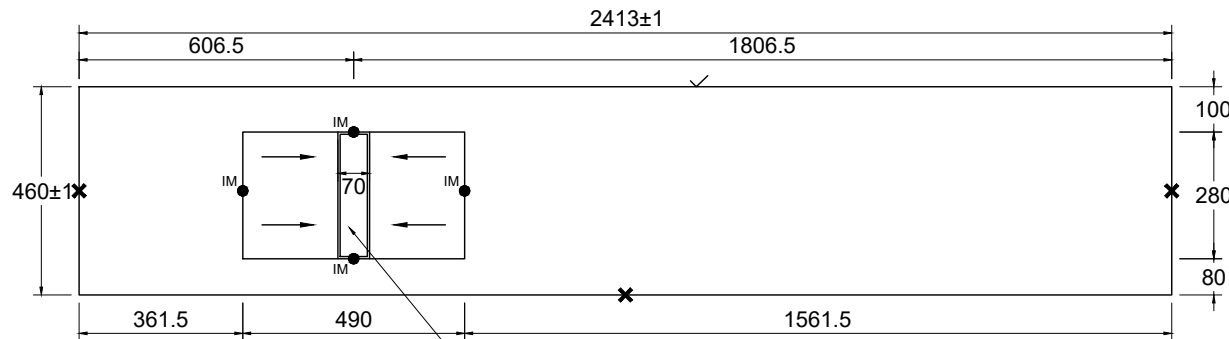

Tapa de Dekton que oculta la válvula
(Dekton lid to cover the drainer)

SECCIÓN
(Section)

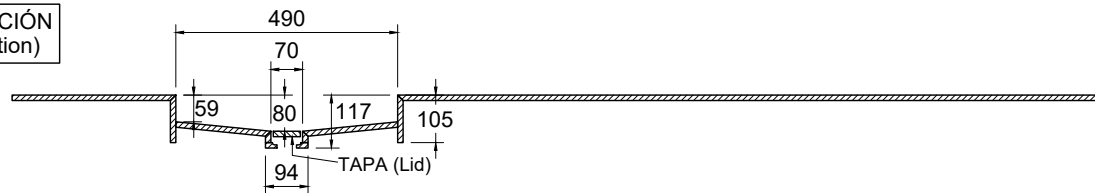

SECCIÓN
(Section)

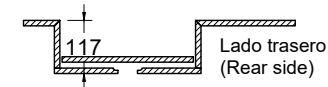

CUBETA
(Basin)

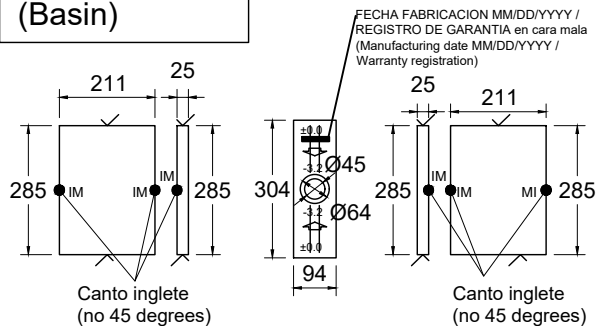

FECHA FABRICACION MM/DD/YYYY /
REGISTRO DE GARANTIA en cara mala
(Manufacturing date MM/DD/YYYY /
Warranty registration)

ESQUEMA DE MONTAJE
(Assembly scheme)

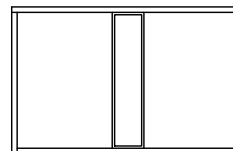

DETALLE VÁLVULA
(Drain hole detail)

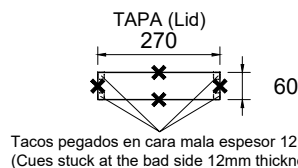
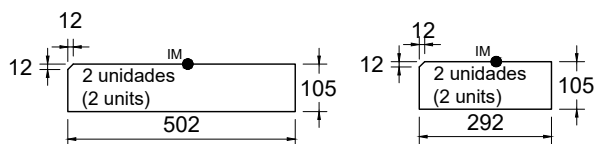
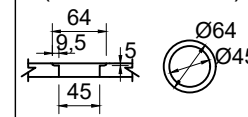

- CANTO RECTO PULIDO**
(Flat polished edge)
- BISEL 2 MM**
(Bevel 2mm)
- CANTO INGLETE 45°**
A LA CARA MALA
(Miter edge 45°)

ENCIMERA
(Vanity Top)



Måltegnning Servant

DEKTON

241 Høyre

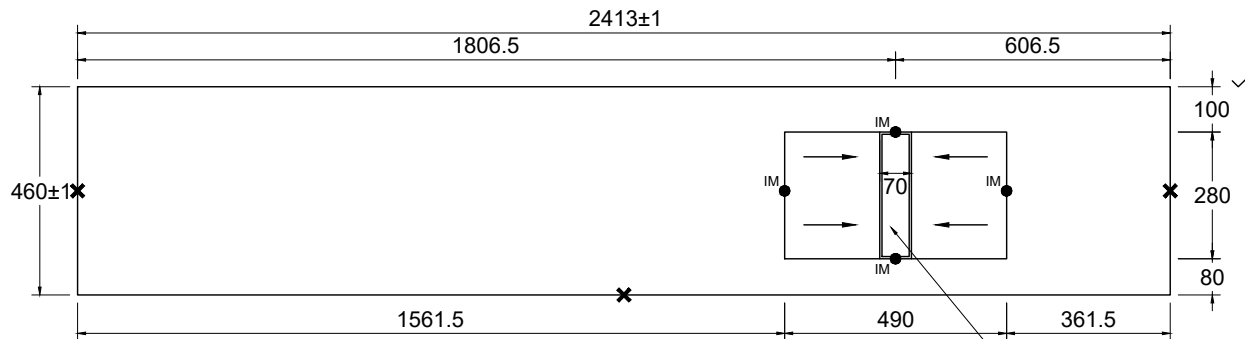

Tapa de Dekton que oculta la válvula
(Dekton lid to cover the drainer)

SECCIÓN
(Section)

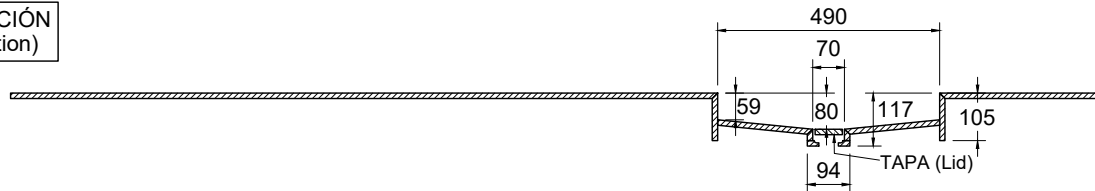

SECCIÓN
(Section)

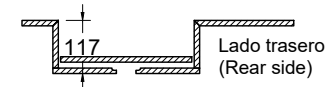

CUBETA
(Basin)

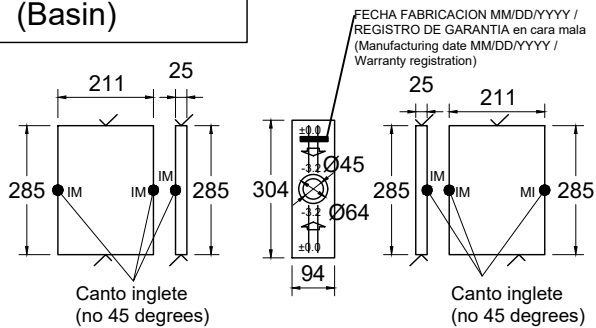

ESQUEMA DE MONTAJE
(Assembly scheme)

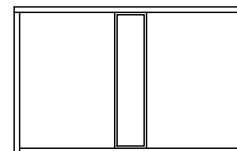

DETALLE VÁLVULA
(Drain hole detail)

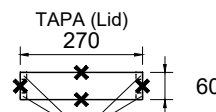
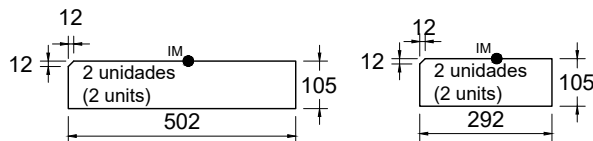
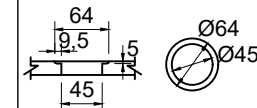

Tacos pegados en cara mala espesor 12 mm
(Cues stuck at the bad side 12mm thickness)

- ✱ CANTO RECTO PULIDO (Flat polished edge)
- ✓ BISEL 2 MM (Bevel 2mm)
- CANTO INGLETE 45° A LA CARA MALA (Miter edge 45°)

ENCIMERA
(Vanity Top)

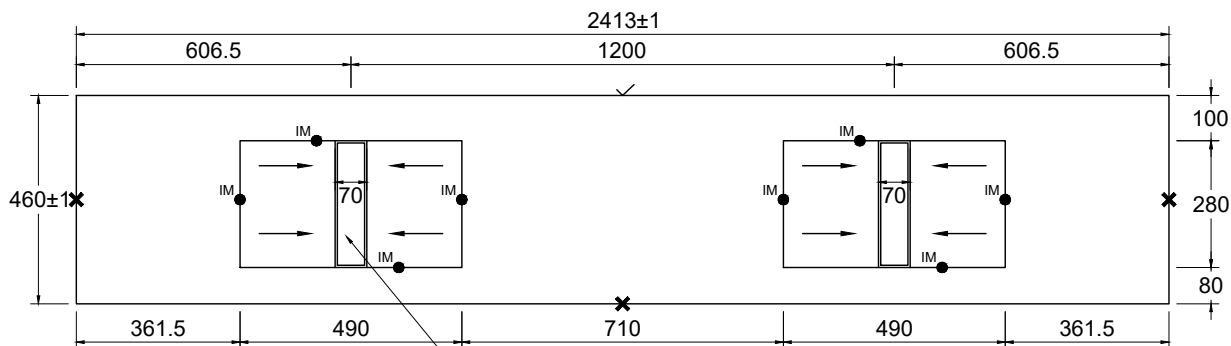

Tapa de Dekton que oculta la válvula
(Dekton lid to cover the drainer)

SECCIÓN
(Section)

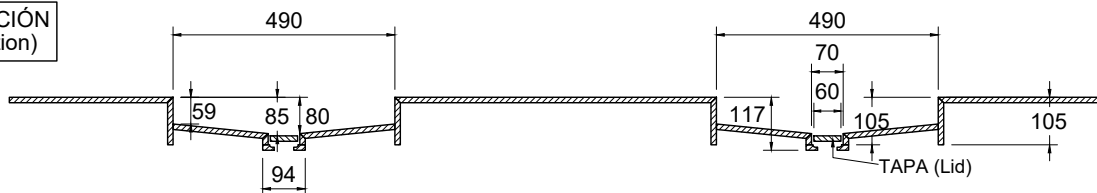

SECCIÓN
(Section)

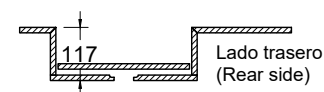

CUBETA 2 un
(Basin)

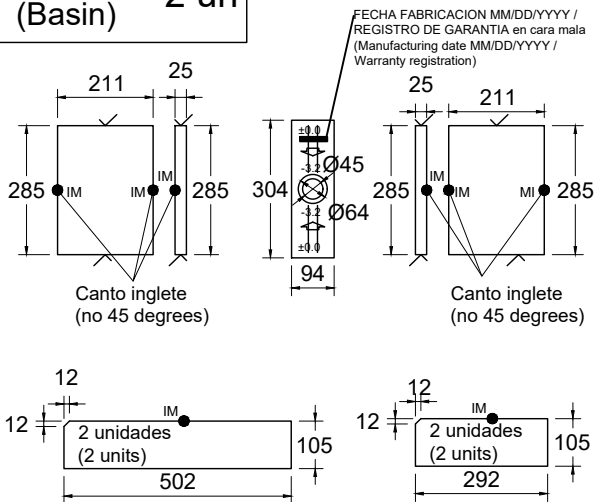

ESQUEMA DE MONTAJE
(Assembly scheme)

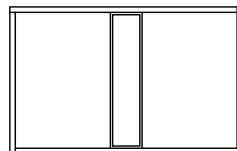

DETALLE VÁLVULA
(Drain hole detail)

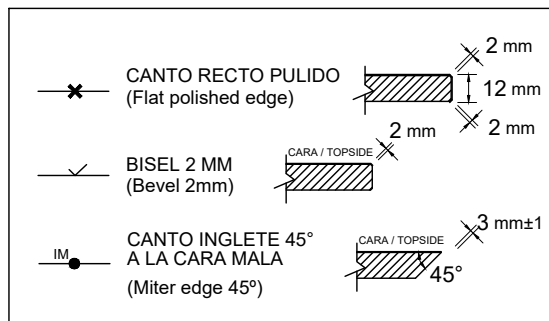
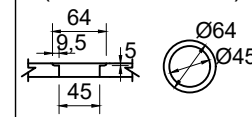

Måltegning Servant

DEKTON

241 Dobbelt